

BLINDER

HP 905 ULTRA LASERJAMMER SYSTEM

Instructions for use

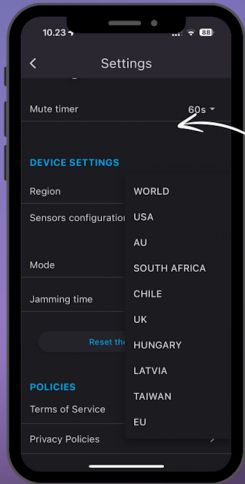

Device settings menu

Region:

- Choose the region of which you drive with the system it is recommended to use world as default if your country is not listed
- The list of laserguns used in the different region is set by default from the manufacture. new versions and laserguns may appear and the manufacture cannot be held responsible for new updates.

Front screen alert / userguide

When the system detects a laser speed enforcement system the car will start to flash, and a high audio alert will start.

- Red markings will show if it is front or rear detection
- An audio sound will inform the type of lasergun used

On the front screen you can use 3 functions:

- The green button, will immediately stop the jamming, this will allow the police to measure your speed, **so be sure to be at the allowed speed before using this.**
- The gray speaker button, will start muting the audio alert for the set time, the car will still flash. (see App settings for mute timing)
- The blue button will enable the user to switch from defense mode (**jamming active**) to receiver mode (**only detection, no jamming**)

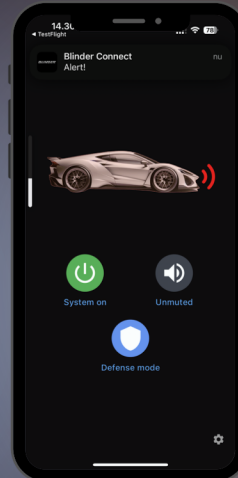

General information

- Download Blinder Connect from
 - **Apple Appstore**
 - **Google play store**
- when connecting for the first time please observe the following
 - **Pairing pin code is 123456**
 - **Allow the App to use Bluetooth connection**
 - **Allow notifications from the App**
 - **set location permission to allow always**

BLINDER



Blinder International Aps. - Industrivej 51F - 4000 Roskilde - Denmark



+45 32 96 32 00



support@blinder.dk

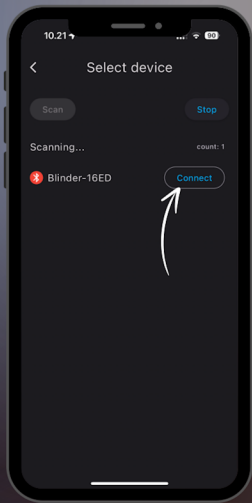

Scan For Device

On this screen you will start the scanning for devices. a list will be shown for devices in vicinity of the phone.

Once a device is found it is shown with the native individual name of the specific bluetooth module.

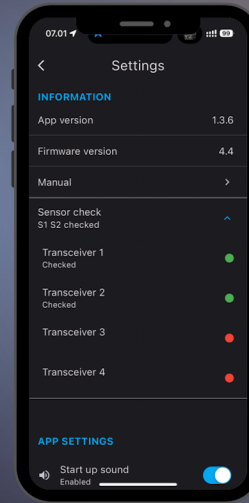

Settings Menu

Information:

Here you will see the current versions of the App and firmware in your product (updates will be done via the App)

Sensor check:

The system will perform a self test, to ensure that the transceivers is connected and receiving signal.

Sensors connected and receiving will be marked in green

Connect Your Device

When your device is connected it will turn green on your screen

After connection you will be able to assign a name to your device. be aware that the native name of the Bluetooth device will be the one shown in the Bluetooth list on the phone

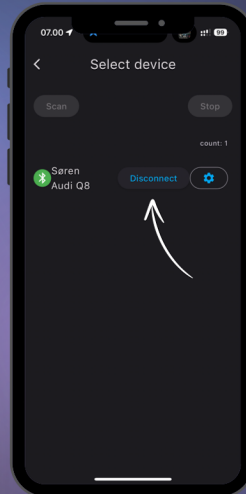

App Settings Menu

This is where you configure the settings in your App:

- Start up sound on/off (welcome speech)
- Speed units MPH / KMH
- Dark or light mode of the App on the phone
- Alert volumes (alert will be set to this volume and will not be affected by the volume adjustment of the phone.
- Vibration when alerting on/off
- Mute timing, set the time you want muting activated
- **(Notification volume is affected by the volume of the phone)**

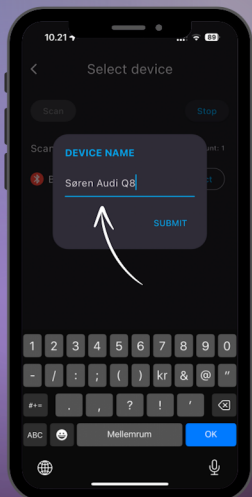
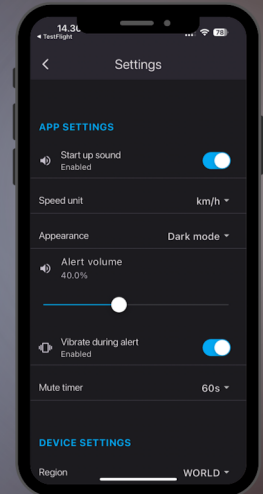

Rename Your Device

When starting up the app for the first time, you will have the option to change the name of your device.

You will also be able to switch between autoconnect (recommended) or manual connection every time you enter the car.

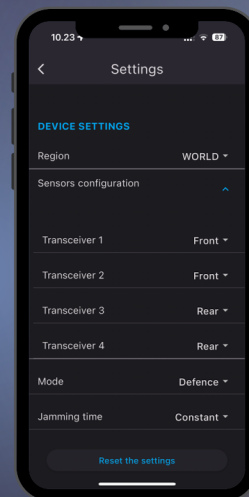

Device Settings Menu

Choose the following settings in the Device settings menu:

- Region (corresponding to laser Guns used in the region)
- Configuration of Gun's
- Configuration of sensors, front/rear
- Mode of the system defence or receive mode
- Jamming time, select from 1-10 seconds or constant